



**IMPORTANT: FOLLOW THE INSTRUCTIONS ON PAGES 8-15**  
 BRYAN COUNTY PLANNING EXPANSION 11/30/2018  
 Bryan County Planning and (3) building owner.

OMB Control Number: 1660-0008  
 11/30/2018

Copy all pages of this Elevation Certificate and all attachments for (1) community official, (2) insurance agent and (3) building owner.

**SECTION A - PROPERTY INFORMATION**

A1. Building Owner's Name Dream Finders Homes, LLC		FOR INSURANCE COMPANY USE	
A2. Building Street Address (including Apt., Unit, Suite, and/or Bldg. No.) or P.O. Route and Box No. 88 Lake Lilly Drive		Policy Number:	Company NAIC Number:
City Richmond Hill	State GA	Zip Code 31324	

A3. Property Description (Lot and Block Numbers, Tax Parcel Number, Legal Description, etc.)  
**Lot 7 Buckhead East Subdivision Phase 4 Lots 1-50**

A4. Building Use (e.g., Residential, Non-Residential, Addition, Accessory, etc.) **Residential**

A5. Latitude/Longitude: Lat. **31°52'39.8"** Long. **81°15'20.5"** Horizontal Datum:  NAD 1927  NAD 1983

A6. Attach at least 2 photographs of the building if the Certificate is being used to obtain flood insurance.

A7. Building Diagram Number **1A**

A8. For a building with a crawlspace or enclosure(s): \_\_\_\_\_ A9. For a building with an attached garage: \_\_\_\_\_

- a) Square footage of crawlspace or enclosure(s) N/A sq ft      a) Square footage of attached garage 432 sq ft
- b) Number of permanent flood openings in the crawlspace or enclosure(s) within 1.0 foot above adjacent grade N/A      b) Number of permanent flood openings in the attached garage within 1.0 foot above adjacent grade N/A
- c) Total net area of flood openings in A8.b N/A sq in      c) Total net area of flood openings in A9.b N/A sq in
- d) Engineered flood openings?  Yes  No      d) Engineered flood openings?  Yes  No

**SECTION B - FLOOD INSURANCE RATE MAP (FIRM) INFORMATION**

B1. NFIP Community Name & Community Number Bryan County 130016	B2. County Name Bryan (unincorporated)	B3. State GA
B4. Map/Panel Number 13029C0295	B5. Suffix C	B6. FIRM Index Date 5/5/2014
B7. FIRM Panel Effective/ Revised Date 3/2/2009	B8. Flood Zone(s) AE	B9. Base Flood Elevation(s) (Zone AO, use base flood depth) 13.0

B10. Indicate the source of the Base Flood Elevation (BFE) data or base flood depth entered in Item B9:  
 FIS Profile  FIRM  Community Determined  Other/Source: \_\_\_\_\_

B11. Indicate elevation datum used for BFE in Item B9:  NGVD 1929  NAVD 1988  Other/Source: \_\_\_\_\_

B12. Is the building located in a Coastal Barrier Resources System (CBRS) area or Otherwise Protected Area (OPA)?  Yes  No  
 Designation Date:  CBRS  OPA

**SECTION C - BUILDING ELEVATION INFORMATION (SURVEY REQUIRED)**

C1. Building elevations are based on:  Construction Drawings\*  Building Under Construction\*  Finished Construction  
 \* A new Elevation Certificate will be required when construction of the building is complete.

C2. Elevations: Zones A1-A30, AE, AH, A (with BFE), VE, V1-V30, V (with BFE), AR, ARA, AR/AE, ARA1-A30, ARAH, ARA/O. Complete items C2.a-h below according to the building diagram specified in item A7. In Puerto Rico only, enter meters.

Benchmark Utilized: **Site** \_\_\_\_\_ Vertical Datum: **NAVD 1988**  
 Indicate elevation datum used for the elevations in items a) through h) below.  NGVD 1929  NAVD 1988  
 Other/Source: \_\_\_\_\_

Datum used for building elevations must be the same as that used for the BFE.

Check the measurement used.

- a) Top of bottom floor (including basement, crawlspace, or enclosure floor) \_\_\_\_\_  feet  meters
- b) Top of the next higher floor \_\_\_\_\_ **28.1**  feet  meters
- c) Bottom of the lowest horizontal structural member (V Zones only) \_\_\_\_\_ **N/A.**  feet  meters
- d) Attached garage (top of slab) \_\_\_\_\_ **17.2**  feet  meters
- e) Lowest elevation of machinery or equipment servicing the building (Describe type of equipment and location in Comments) \_\_\_\_\_ **17.2**  feet  meters
- f) Lowest adjacent (finished) grade next to building (LAG) \_\_\_\_\_ **16.9**  feet  meters
- g) Highest adjacent (finished) grade next to building (HAG) \_\_\_\_\_ **17.1**  feet  meters
- h) Lowest adjacent grade at lowest elevation of deck or stairs, including structural support \_\_\_\_\_ **17.0**  feet  meters

**IMPORTANT: In these spaces, copy the corresponding information from Section A.**  
 Building Street Address (including Apt., Unit, Suite, and/or Bldg. No.) or P.O. Route and Box No.  
 88 Lake Lilly Drive

**FOR INSURANCE COMPANY USE**  
 Policy Number:

City Richmond Hill State GA Zip Code 31324

Company NAIC Number:

**SECTION D - SURVEYOR, ENGINEER, OR ARCHITECT CERTIFICATION**

This certification is to be signed and sealed by a land surveyor, engineer, or architect authorized by law to certify elevation information. I certify that the information on this Certificate represents my best efforts to interpret the data available. I understand that any false statement may be punishable by fine or imprisonment under 18 U.S. Code, Section 1001.

Were latitude and longitude in Section A provided by a licensed land surveyor?  
 Yes  No

Certifier's Name David A. Brunson License Number 2538

Title President Company Name Southeast Georgia Surveying, P.C.

Address 518 Edsel Drive, Suite D City Richmond Hill State GA Zip Code 31324

Signature  Date 11/24/2017 Telephone 912 756-2211

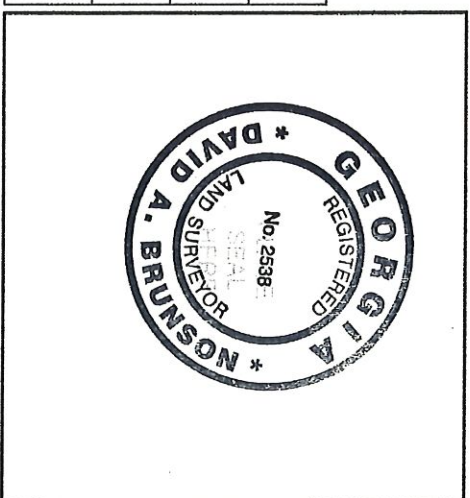

Copy all pages of this Elevation Certificate for (1) community official, (2) insurance agent/company, and (3) building owner.

Comments (including type of equipment and location, per C2(e), if applicable)  
**Job #17-65 Lot 7 Buckhead East Ph 4 Latitude and Longitude were obtained using a hand held GPS unit (Carlson Mini 2). The lowest servicing equipment for C2e is an A/C unit located on the left side of house.**

Signature  Date 11/24/2017

**SECTION E - BUILDING ELEVATION INFORMATION (SURVEY NOT REQUIRED) FOR ZONE AO AND ZONE A (WITHOUT BFE)**

For Zones AO and A (without BFE), complete items E1-E5. If the Certificate is intended to support a LOMA or LOMR-F request, complete Sections A, B, and C. For items E1-E4, use natural grade, if available. Check the measurement used. In Puerto Rico only, enter meters.

E1. Provide elevation information for the following and check the appropriate boxes to show whether the elevation is above or below the highest adjacent grade (HAG) and the lowest adjacent grade (LAG).

- a) Top of bottom floor (including basement, crawlspace, or enclosure) is \_\_\_\_\_ feet  meters  above or  below the HAG.
- b) Top of bottom floor (including basement, crawlspace, or enclosure) is \_\_\_\_\_ feet  meters  above or  below the LAG.
- E2. For Building Diagrams 6-9 with permanent flood openings provided in Section A items 8 and/or 9 (see page 8 of Instructions), the next higher floor (elevation C2.b in the diagrams) of the building is \_\_\_\_\_ feet  meters  above or  below the HAG.
- E3. Attached garage (top of slab) is \_\_\_\_\_ feet  meters  above or  below the HAG.
- E4. Top of platform of machinery and/or equipment servicing the building is \_\_\_\_\_ feet  meters  above or  below the HAG.
- E5. Zone AO only: If no flood depth number is available, is the top of the bottom floor elevated in accordance with the community's floodplain management ordinance?  Yes  No  Unknown. The local official must certify this information in Section G.

**SECTION F - PROPERTY OWNER (OR OWNERS REPRESENTATIVE) CERTIFICATION**

The property owner or owner's authorized representative who completes Sections A, B, and E for Zone A (without a FEMA-issued or community-issued BFE) or Zone AO must sign here. The statements in Sections A, B, and E are correct to the best of my knowledge.

Property Owner or Owner's Authorized Representative's Name

Address City State ZIP Code

Signature Date Telephone

Comments

Check here if attachments.

**IMPORTANT: In these spaces, copy the corresponding information from Section A.**  
Building Street Address (including Apt., Unit, Suite, and/or Bldg. No.) or P.O. Route and Box No.  
88 Lake Lilly Drive

**FOR INSURANCE COMPANY USE**  
Policy Number:

City Richmond Hill State GA Zip Code 31324

Company NAIC Number:

**SECTION G - COMMUNITY INFORMATION (OPTIONAL)**

The local official who is authorized by law or ordinance to administer the community's floodplain management ordinance can complete Sections A, B, C (or E), and G of this Elevation Certificate. Complete the applicable item(s) and sign below. Check the measurement used in Items G8-G10. In Puerto Rico only, enter meters.

G1.  The information in Section C was taken from other documentation that has been signed and sealed by a licensed surveyor, engineer, or architect who is authorized by law to certify elevation information. (Indicate the source and date of the elevation data in the Comments area below.)

G2.  A community official completed Section E for a building located in Zone A (without a FEMA-issued or community-issued BFE) or Zone AO.

G3.  The following information (Items G4-G10) is provided for community floodplain management purposes.

G4. Permit Number	G5. Date Permit Issued	G6. Date Certificate of Compliance/Occupancy Issued
-------------------	------------------------	---

G7. This permit has been issued for:  New Construction  Substantial Improvement

G8. Elevation of as-built lowest floor (including basement) of the building: \_\_\_\_\_  feet  meters Datum \_\_\_\_\_

G9. BFE or (in Zone AO) depth of flooding at the building site: \_\_\_\_\_  feet  meters Datum \_\_\_\_\_

G10. Community's design flood elevation: \_\_\_\_\_  feet  meters Datum \_\_\_\_\_

Local Official's Name \_\_\_\_\_ Title \_\_\_\_\_

Community Name \_\_\_\_\_ Telephone \_\_\_\_\_

Signature \_\_\_\_\_ Date \_\_\_\_\_

Comments (including type of equipment and location, per C2(e), if applicable)

Check here if attachments.

**ELEVATION CERTIFICATE, page 4**      **BUILDING PHOTOGRAPHS**

OMB Control Number: 1660-0008

See instructions for Item A6.

Expiration: 11/30/2018

<b>IMPORTANT: In these spaces, copy the corresponding information from Section A.</b>		<b>FOR INSURANCE COMPANY USE</b>
Building Street Address (including Apt., Unit, Suite, and/or Bldg. No.) or P. O. Route and Box No. 88 Lake Lilly Drive		Policy Number:
City Richmond Hill	State GA	Zip Code 31324
		Company NAIC Number:

If using the Elevation Certificate to obtain NFIP flood insurance, affix at least 2 building photographs below according to the instructions for Item A6. Identify all photographs with date taken; "Front view" and Rear view", and, if required, "Right Side View" and "Left Side View." When applicable, photographs must show the foundation with representative examples of the flood openings or vents, as indicated in Section A8. If submitting more photographs than will fit on this page, use the Continuation Page.



Front View taken 11/20/2017



Rear View taken 11/20/2017