

ELEVATION CERTIFICATE

IMPORTANT: FOLLOW THE INSTRUCTIONS ON PAGES 8-15

OMB Control Number: 1660-0008
Expiration: 11/30/2018

Copy all pages of this Elevation Certificate and all attachments for (1) community official, (2) insurance agent/company, and (3) building owner.

SECTION A - PROPERTY INFORMATION		FOR INSURANCE COMPANY USE	
A1. Building Owner's Name Ernest Signature Custom Homes, LLC.		Policy Number:	
A2. Building Street Address (including Apt., Unit, Suite, and/or Bldg. No.) or P.O. Route and Box No. 15 Clapper Rail Rd.		Company NAIC Number:	
City Richmond Hill	State GA	Zip Code 31324	
A3. Property Description (Lot and Block Numbers, Tax Parcel Number, Legal Description, etc.) Lot 101 Dunham Marsh Phase 3C			
A4. Building Use (e.g., Residential, Non-Residential, Addition, Accessory, etc.) Residential			
A5. Latitude/Longitude: Lat. 31°51'17.9" Long. 81°16'55.8		Horizontal Datum: <input type="radio"/> NAD 1927 <input checked="" type="radio"/> NAD 1983	
A6. Attach at least 2 photographs of the building if the Certificate is being used to obtain flood insurance.			
A7. Building Diagram Number 1B			
A8. For a building with a crawlspace or enclosure(s): A9. For a building with an attached garage: a) Square footage of crawlspace or enclosure(s) N/A sq ft a) Square footage of attached garage 655 sq ft b) Number of permanent flood openings in the crawlspace or enclosure(s) within 1.0 foot above adjacent grade N/A b) Number of permanent flood openings in the attached garage within 1.0 foot above adjacent grade 4			
c) Total net area of flood openings in A8.b N/A sq in c) Total net area of flood openings in A9.b 820 sq in			
d) Engineered flood openings? <input type="radio"/> Yes <input checked="" type="radio"/> No d) Engineered flood openings? <input type="radio"/> Yes <input checked="" type="radio"/> No			
SECTION B - FLOOD INSURANCE RATE MAP (FIRM) INFORMATION			
B1. NFIP Community Name & Community Number Bryan County 130016		B2. County Name Bryan (unincorporated)	B3. State GA
B4. Map/Panel Number 13029C0375	B5. Suffix C	B6. FIRM Index Date 5/5/2014	B7. FIRM Panel Effective/ Revised Date 3/2/2009
		B8. Flood Zone(s) AE	B9. Base Flood Elevation(s) (Zone AO, use base flood depth) 12.0
B10. Indicate the source of the Base Flood Elevation (BFE) data or base flood depth entered in Item B9: <input type="radio"/> FIS Profile <input checked="" type="radio"/> FIRM <input type="radio"/> Community Determined <input type="radio"/> Other/Source: _____			
B11. Indicate elevation datum used for BFE in Item B9: <input type="radio"/> NGVD 1929 <input checked="" type="radio"/> NAVD 1988 <input type="radio"/> Other/Source: _____			
B12. Is the building located in a Coastal Barrier Resources System (CBRS) area or Otherwise Protected Area (OPA)? <input type="radio"/> Yes <input checked="" type="radio"/> No Designation Date: <input type="radio"/> CBRS <input type="radio"/> OPA			
SECTION C - BUILDING ELEVATION INFORMATION (SURVEY REQUIRED)			
C1. Building elevations are based on: <input type="radio"/> Construction Drawings* <input type="radio"/> Building Under Construction* <input checked="" type="radio"/> Finished Construction * A new Elevation Certificate will be required when construction of the building is complete.			
C2. Elevations: Zones A1-A30, AE, AH, A (with BFE), VE, V1-V30, V (with BFE), AR, AR/A, AR/AE, AR/A1-A30, AR/AH, AR/AO. Complete Items C2.a-h below according to the building diagram specified in Item A7. In Puerto Rico only, enter meters. Benchmark Utilized: AB3037 Vertical Datum: NAVD 1988			
Indicate elevation datum used for the elevations in items a) through h) below. <input type="radio"/> NGVD 1929 <input checked="" type="radio"/> NAVD 1988 <input type="radio"/> Other/Source: _____			
Datum used for building elevations must be the same as that used for the BFE. Check the measurement used.			
a) Top of bottom floor (including basement, crawlspace, or enclosure floor)	13.3	<input checked="" type="radio"/> feet	<input type="radio"/> meters
b) Top of the next higher floor	24.8	<input checked="" type="radio"/> feet	<input type="radio"/> meters
c) Bottom of the lowest horizontal structural member (V Zones only)	N/A.	<input checked="" type="radio"/> feet	<input type="radio"/> meters
d) Attached garage (top of slab)	11.9	<input checked="" type="radio"/> feet	<input type="radio"/> meters
e) Lowest elevation of machinery or equipment servicing the building (Describe type of equipment and location in Comments)	13.8	<input checked="" type="radio"/> feet	<input type="radio"/> meters
f) Lowest adjacent (finished) grade next to building (LAG)	11.0	<input checked="" type="radio"/> feet	<input type="radio"/> meters
g) Highest adjacent (finished) grade next to building (HAG)	11.6	<input checked="" type="radio"/> feet	<input type="radio"/> meters
h) Lowest adjacent grade at lowest elevation of deck or stairs, including structural support	11.2	<input checked="" type="radio"/> feet	<input type="radio"/> meters

ELEVATION CERTIFICATE, page 2

OMB Control Number: 1660-0008
Expiration: 11/30/2018

IMPORTANT: In these spaces, copy the corresponding information from Section A.	FOR INSURANCE COMPANY USE
Building Street Address (including Apt., Unit, Suite, and/or Bldg. No.) or P.O. Route and Box No. 15 Clapper Rail Rd.	Policy Number:
City Richmond Hill	Company NAIC Number.
State GA	Zip Code 31324
SECTION D - SURVEYOR, ENGINEER, OR ARCHITECT CERTIFICATION	

This certification is to be signed and sealed by a land surveyor, engineer, or architect authorized by law to certify elevation information. I certify that the information on this Certificate represents my best efforts to interpret the data available. I understand that any false statement may be punishable by fine or imprisonment under 18 U.S. Code, Section 1001.

Check here if attachments. Were latitude and longitude in Section A provided by a licensed land surveyor?
 Yes No

Certifier's Name David A. Brunson	License Number 2538
Title President	
Company Name Southeast Georgia Surveying, P.C.	
Address 518 Edsel Drive, Suite D	City Richmond Hill
	State GA
	Zip Code 31324
Signature 	Date 06/28/2016
	Telephone 912 756-2211

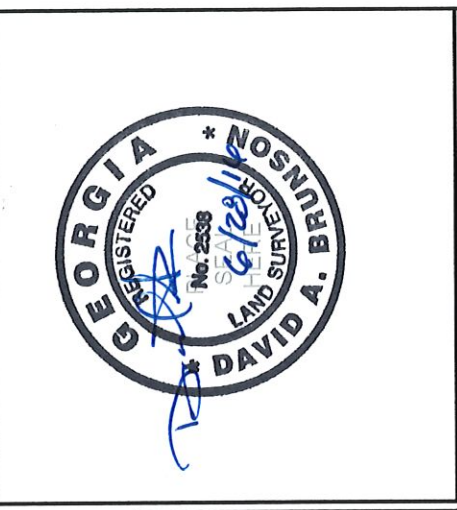

Copy all pages of this Elevation Certificate for (1) community official, (2) insurance agent/company, and (3) building owner.

Comments (including type of equipment and location, per C2(e), if applicable)
Job #15-177(101) Lot 101 Dunham Marsh Ph 3C Latitude and Longitude were obtained from Google Earth. The lowest servicing equipment is an A/C unit located on the right side of house. Engineered flood openings for the garage are model number 816CS. An engineer's certification statement is attached with this elevation certificate.

Signature  Date **06/28/2016**

SECTION E - BUILDING ELEVATION INFORMATION (SURVEY NOT REQUIRED) FOR ZONE AO AND ZONE A (WITHOUT BFE)

For Zones AO and A (without BFE), complete Items E1-E5. If the Certificate is intended to support a LOMA or LOMR-F request, complete Sections A, B, and C. For items E1-E4, use natural grade, if available. Check the measurement used. In Puerto Rico only, enter meters.

E1. Provide elevation information for the following and check the appropriate boxes to show whether the elevation is above or below the highest adjacent grade (HAG) and the lowest adjacent grade (LAG).

- a) Top of bottom floor (including basement, crawlspace, or enclosure) is _____ feet meters above or below the HAG.
- b) Top of bottom floor (including basement, crawlspace, or enclosure) is _____ feet meters above or below the LAG.
- E2. For Building Diagrams 6-9 with permanent flood openings provided in Section A items 8 and/or 9 (see page 8 of Instructions), the next higher floor (elevation C2.b in the diagrams) of the building is _____ feet meters above or below the HAG.
- E3. Attached garage (top of slab) is _____ feet meters above or below the HAG.
- E4. Top of platform of machinery and /or equipment servicing the building is _____ feet meters above or below the HAG.
- E5. Zone AO only: If no flood depth number is available, is the top of the bottom floor elevated in accordance with the community's floodplain management ordinance? Yes No Unknown. The local official must certify this information in Section G.

SECTION F - PROPERTY OWNER (OR OWNER'S REPRESENTATIVE) CERTIFICATION

The property owner or owner's authorized representative who completes Sections A, B, and E for Zone A (without a FEMA-issued or community-issued BFE) or Zone AO must sign here. The statements in Sections A, B, and E are correct to the best of my knowledge.

Property Owner or Owner's Authorized Representative's Name _____

Address _____ City _____ State _____ Zip Code _____

Signature _____ Date _____ Telephone _____

Comments _____

Check here if attachments

ELEVATION CERTIFICATE, page 3

OMB Control Number: 1660-0008
Expiration: 1/30/2018

IMPORTANT: In these spaces, copy the corresponding information from Section A.		FOR INSURANCE COMPANY USE
Building Street Address (including Apt., Unit, Suite, and/or Bldg. No.) or P.O. Route and Box No. 15 Clapper Rail Rd.		Policy Number:
City Richmond Hill	State GA	Zip Code 31324
SECTION G - COMMUNITY INFORMATION (OPTIONAL)		
The local official who is authorized by law or ordinance to administer the community's floodplain management ordinance can complete Sections A, B, C (or E), and G of this Elevation Certificate. Complete the applicable item(s) and sign below. Check the measurement used in items G8-G10. In Puerto Rico only, enter meters.		
G1. <input type="checkbox"/> The information in Section C was taken from other documentation that has been signed and sealed by a licensed surveyor, engineer, or architect who is authorized by law to certify elevation information. (Indicate the source and date of the elevation data in the comments area below.)		
G2. <input type="checkbox"/> A community official completed Section E for a building located in Zone A (without a FEMA-issued or community-issued BFE) or Zone AO.		
G3. <input type="checkbox"/> The following information (Items G4-G10) is provided for community floodplain management purposes.		
G4. Permit Number	G5. Date Permit Issued	G6. Date Certificate of Compliance/Occupancy Issued
G7. This permit has been issued for: <input type="radio"/> New Construction <input type="radio"/> Substantial Improvement		
G8. Elevation of as-built lowest floor (including basement) of the building: _____ . _____ <input type="radio"/> feet <input type="radio"/> meters Datum _____		
G9. BFE or (in Zone AO) depth of flooding at the building site: _____ . _____ <input type="radio"/> feet <input type="radio"/> meters Datum _____		
G10. Community's design flood elevation: _____ . _____ <input type="radio"/> feet <input type="radio"/> meters Datum _____		
Local Official's Name _____ Title _____		
Community Name _____ Telephone _____		
Signature _____ Date _____		
Comments (including type of equipment and location, per C2(e), if applicable)		

Check here if attachments.

ELEVATION CERTIFICATE, page 4

BUILDING PHOTOGRAPHS

See instructions for Item A6.

OMB Control Number: 1660-0008
Expiration: 11/30/2018

IMPORTANT: In these spaces, copy the corresponding information from Section A.		FOR INSURANCE COMPANY USE
Building Street Address (including Apt., Unit, Suite, and/or Bldg. No.) or P.O. Route and Box No. 15 Clapper Rail Rd.		Policy Number:
City Richmond Hill	State GA	Company NAIC Number:
	Zip Code 31324	

If using the Elevation Certificate to obtain NFIP flood insurance, affix at least 2 building photographs below according to the instructions for Item A6. Identify all photographs with date taken; "Front view" and Rear view"; and, if required, "Right Side View" and "Left Side View." When applicable, photographs must show the foundation with representative examples of the flood openings or vents, as indicated in Section A8. If submitting more photographs than will fit on this page, use the Continuation Page.



Front View



Rear View



Engineered Flood Vents (typical)